

5KCM1204



**KitchenAid**

# TABLE OF CONTENTS

<b>COFFEE MAKER SAFETY</b> .....	6
Important safeguards .....	6
Electrical requirements .....	9
Electrical equipment waste disposal .....	9
<b>PARTS AND FEATURES</b> .....	10
Parts and accessories .....	10
Display and control panel features .....	11
<b>OPERATING THE COFFEE MAKER</b> .....	12
Installing the water filter .....	12
Setting the clock .....	14
Setting brew strength .....	14
Filling the Coffee Maker with water for brewing .....	15
Pause and pour feature .....	15
Filling the filter basket .....	16
Coffee dosage guide .....	17
Programming the auto feature .....	18
Using the previously programmed auto time .....	19
Brewing coffee .....	20
<b>CARE AND CLEANING</b> .....	21
Cleaning the Coffee Maker .....	21
<b>TROUBLESHOOTING</b> .....	23
<b>WARRANTY AND SERVICE</b> .....	24

# COFFEE MAKER SAFETY

## Your safety and the safety of others are very important.

We have provided many important safety messages in this manual and on your appliance. Always read and obey all safety messages.



This is the safety alert symbol.

This symbol alerts you to potential hazards that can kill or hurt you and others.

All safety messages will follow the safety alert symbol and either the word “DANGER” or “WARNING.” These words mean:



**You can be killed or seriously injured if you don't immediately follow instructions.**



**You can be killed or seriously injured if you don't follow instructions.**

All safety messages will tell you what the potential hazard is, tell you how to reduce the chance of injury, and tell you what can happen if the instructions are not followed.

## IMPORTANT SAFEGUARDS

**When using electrical appliances, basic safety precautions should always be followed, including the following:**

1. Read all instructions. Misuse of appliance may result in personal injury.
2. The heating element surface is subject to residual heat after use. Do not touch hot surfaces. Use handles or knobs.
3. To protect against fire, electric shock and personal injury do not immerse cord, plugs, or appliance in water or other liquids.

## COFFEE MAKER SAFETY

4. This appliance can be used by children aged from 8 years and above, and persons with reduced physical, sensory, or mental capabilities or lack of experience and knowledge if they have been given supervision or instruction concerning use of the appliance in a safe way and understand the hazards involved. Children shall not play with the appliance. Cleaning and user maintenance shall not be made by children unless they are older than 8 years and are supervised.
5. Keep the appliance and its cord out of reach of children under 8 years of age.
6. Unplug the Coffee Maker from outlet when not in use and before cleaning. Allow to cool before putting on or taking off parts and before cleaning the appliance.
7. Do not operate any appliance with a damaged cord or plug or after the appliance malfunctions or has been damaged in any manner. Return appliance to the nearest Authorised Service Facility for examination, repair, or adjustment.
8. The use of accessory attachments not recommended by the appliance manufacturer may cause injuries.
9. Do not use outdoors.
10. Do not let cord hang over edge of table or counter, or touch hot surfaces.
11. Do not place on or near a hot gas or electric burner, or in a heated oven.
12. Do not use appliance for other than intended use. Misuse of the appliance may result in personal injury.

## **COFFEE MAKER SAFETY**

13. Do not use appliance without lid properly placed on carafe.
14. The carafe is designed for use with this appliance. It must never be used on a range top or in a microwave oven.
15. Do not set a hot carafe on a wet or cold surface.
16. Do not use a cracked carafe or a carafe having a loose or weakened handle.
17. Do not clean carafe with abrasive cleaners, steel wool pads, or other abrasive material.
18. Scalding may occur if the brew basket is opened during the brew cycles.

## **SAVE THESE INSTRUCTIONS**

**THIS PRODUCT IS DESIGNED FOR HOUSEHOLD USE ONLY.**

# COFFEE MAKER SAFETY

## ELECTRICAL REQUIREMENTS

### **! WARNING**



#### **Electrical Shock Hazard**

**Plug into an earthed outlet.**

**Do not remove earth prong.**

**Do not use an adapter.**

**Do not use an extension cord.**

**Failure to follow these instructions can result in death, fire, or electrical shock.**

**Volts:** 220-240 VAC

**Hertz:** 50-60 Hz

**Wattage:** 1100 Watts

**NOTE:** This Coffee Maker has a grounded plug. To reduce the risk of electrical shock, this plug will fit in an outlet only one way. If the plug does not fit in the outlet, contact a qualified electrician. Do not modify the plug in any way.

Do not use an extension cord. If the power supply cord is too short, have a qualified electrician or service personnel install an outlet near the appliance.

## ELECTRICAL EQUIPMENT WASTE DISPOSAL

### **Disposal of packing material**

The packing material is 100% recyclable and is marked with the recycle symbol . The various parts of the packing must therefore be disposed of responsibly and in full compliance with local authority regulations governing waste disposal.

### **Scrapping the product**

- This appliance is marked in compliance with European Directive 2012/19/EU, Waste Electrical and Electronic Equipment (WEEE).

- By ensuring this product is disposed of correctly, you will help prevent potential negative consequences for the environment and human health, which could otherwise be caused by inappropriate waste handling of this product.



- The symbol  on the product or on the accompanying documentation indicates that it should not be treated as domestic waste but must be taken to an appropriate collection Centre for the recycling of electrical and electronic equipment.

For more detailed information about treatment, recovery and recycling of this product, please contact your local city office, your household waste disposal service or the shop where you purchased the product.

# PARTS AND FEATURES

## PARTS AND ACCESSORIES

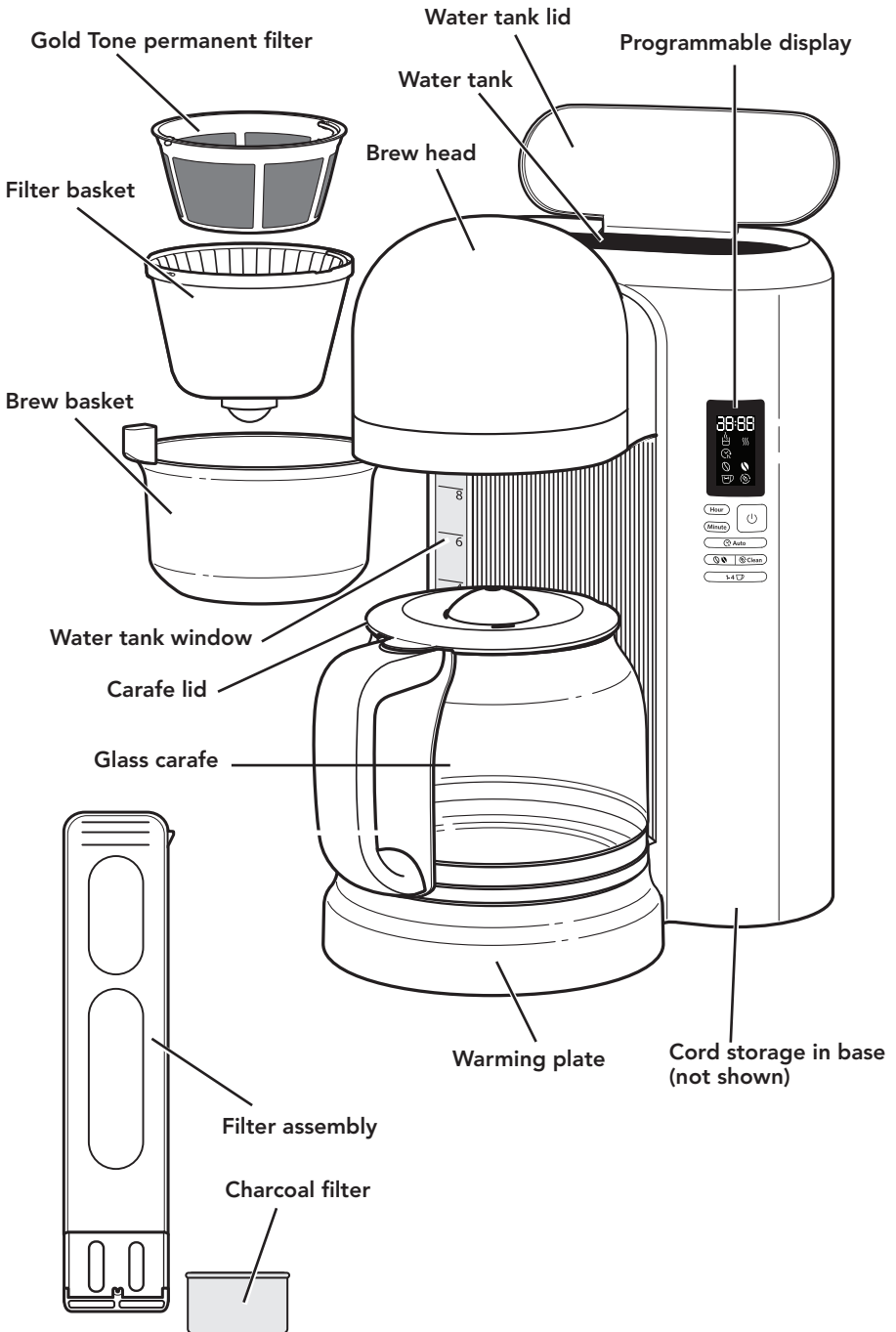

# PARTS AND FEATURES

## DISPLAY AND CONTROL PANEL FEATURES

### Programmable display

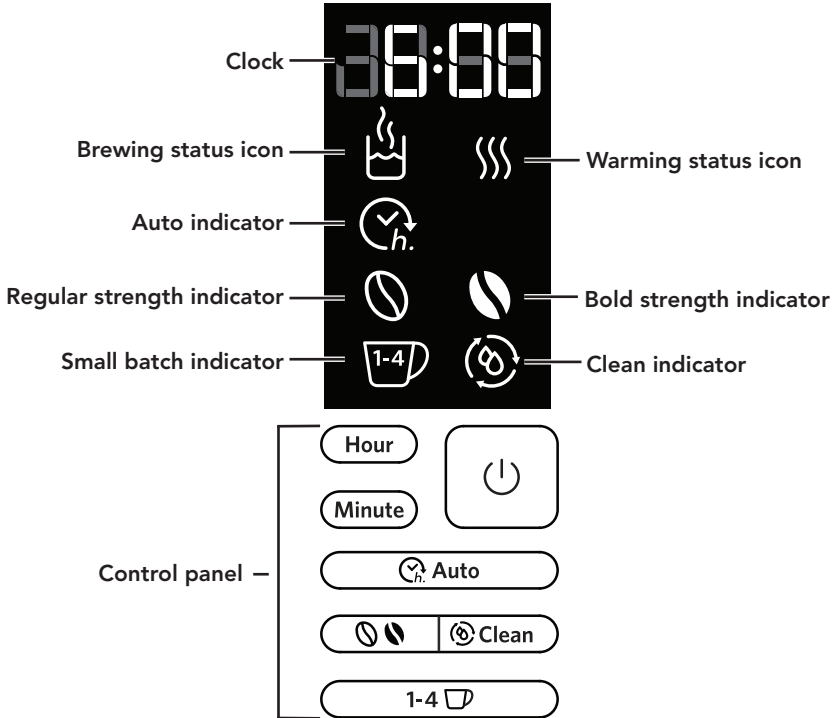



# OPERATING THE COFFEE MAKER

## INSTALLING THE WATER FILTER

### Before first use

Wash the Gold Tone permanent filter, filter basket, and carafe in hot, soapy water; then rinse with clean water and dry. Do not use abrasive cleansers or scouring pads.

**NOTE:** These parts can also be washed in the top rack of the dishwasher.

### Installing the charcoal filter:

Using the filter is optional but strongly recommended. The Coffee Maker will operate normally without the filter, but it reduces contaminants that can impair coffee flavour.

The filter is for use only with municipally treated tap water or well water that is regularly tested for contaminants; it is not intended to remove contaminants in water that is not suitable for drinking.

**IMPORTANT:** Every time you install a new water filter, run the Coffee Maker through a complete brew cycle without coffee. Use a full carafe of clean, cool water.

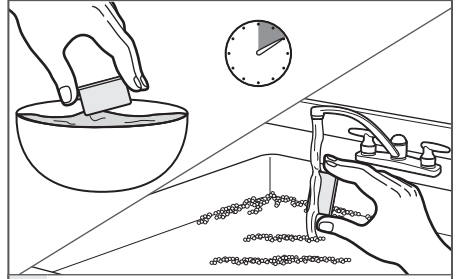

**1** Place the charcoal filter in a container filled with fresh, cool water. The charcoal filter should remain submerged in the water for 10 minutes. Rinse the charcoal filter under running water for 5 seconds after soaking.

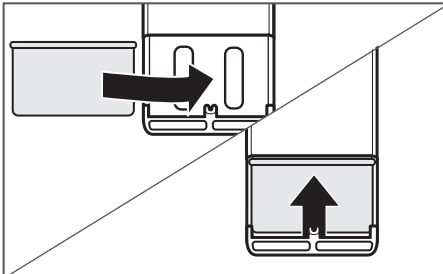

**2** Put the charcoal filter into the filter assembly. Snap to close.

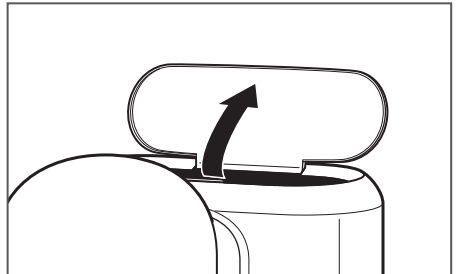

**3** Lift the water tank lid using the tab at the front of the lid.

# OPERATING THE COFFEE MAKER

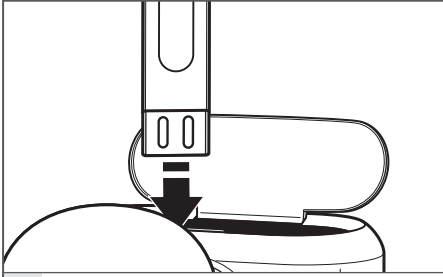

4

Place the filter assembly in the well at the bottom of the water reservoir. Push the filter assembly slightly to make sure it fits snugly.

## ⚠ WARNING



### Electrical Shock Hazard

**Plug into an earthed outlet.**

**Do not remove earth prong.**

**Do not use an adapter.**

**Do not use an extension cord.**

**Failure to follow these instructions can result in death, fire, or electrical shock.**

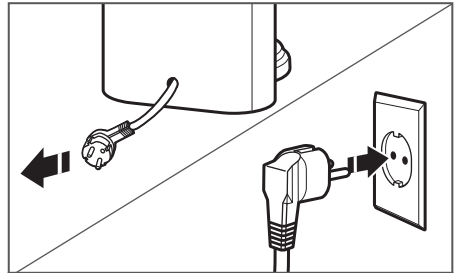

5

Cord is stored in base. If needed, gently pull cord outwards until fully extended or just long enough to reach the outlet. Plug into a grounded outlet.

# OPERATING THE COFFEE MAKER

## SETTING THE CLOCK

**NOTE:** When the Coffee Maker is first plugged in or when power is restored after an interruption, the display will initially show 12:00.

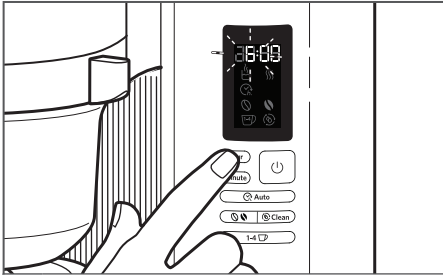

- 1 To set the hour: Press HOUR. The Hour setting will begin to blink. The hour digits will change with each press; or press and hold to scroll rapidly.

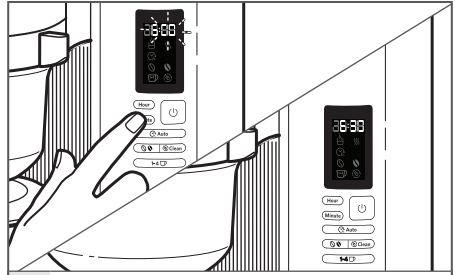

- 2 To set the minutes: Press MINUTE. The Hour setting will switch to a solid display and the Minute setting will begin to blink. The Minute digits will change with each press, or press and hold to scroll rapidly.  
To save the current displayed time and exit clock set up: Wait for 10 seconds or press any button (Auto, Clean, 1-4, Power).

## SETTING BREW STRENGTH

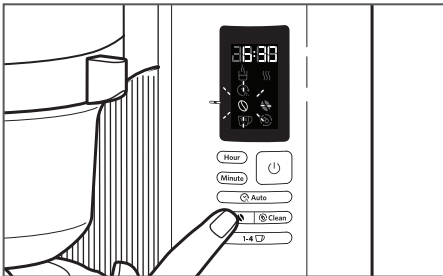

- 1 To switch between Regular (☺) and Bold (☹) brew strengths: Press BREW STRENGTH to toggle between Regular and Bold until you reach the strength desired.

**NOTE:** Regular is the default setting.

# OPERATING THE COFFEE MAKER

## FILLING THE COFFEE MAKER WITH WATER FOR BREWING

**TIP:** Brew two pots of fresh, cool water and discard before brewing the first pot of coffee.

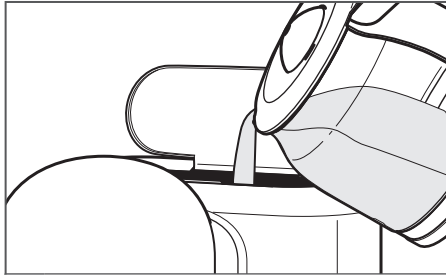

1

Lift the water tank lid and fill with enough fresh, cool water to make the desired amount of coffee. Use the cup indicators on the water tank window to view water input. Close the water tank lid.

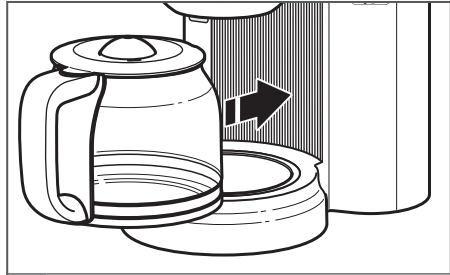

2

Place the carafe in the Coffee Maker. Make sure the bottom of the carafe is fully seated; otherwise, the Pause and pour feature may not engage, causing water and coffee to overflow the filter basket.

**NOTE:** When using the Small Batch brew cycle, make sure to fill the tank with only the amount of water needed to brew your desired number of cups. If you put in 12 cups of water, the Coffee Maker will brew all 12 cups.

## PAUSE AND POUR FEATURE

The Pause and pour feature enables you to remove the carafe from the Coffee Maker and pour a cup of coffee before brewing is finished. When the carafe is removed, a special valve stops the flow of coffee from the filter basket. However, brewing does not stop. If the carafe is not placed back in the Coffee Maker within 25 seconds, water and coffee grounds will overflow the filter basket.

# OPERATING THE COFFEE MAKER

## FILLING THE FILTER BASKET

**NOTE:** Do not operate the Coffee Maker without the filter basket in place.

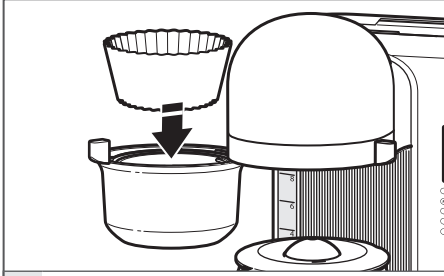

- 1** Open the brew basket. Make sure the filter basket and filter are placed inside of the basket door before adding coffee.

**NOTE:** If you do not wish to use the Gold Tone permanent filter, you may use a 12-cup, flat bottom paper coffee filter instead; do not use both together.

When using a paper coffee filter, place the filter inside the filter basket, pressing the filter into the sides of the filter basket. Pre-wetting the paper filter is not required. The paper coffee filter needs to be placed in the filter basket before adding ground coffee.

If using the Gold Tone permanent filter, you may remove the filter from the filter basket to add ground coffee, if desired.

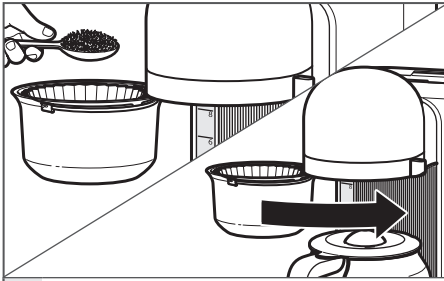

- 2** Use the "Coffee dosage guide" to add the appropriate amount of ground coffee to the filter basket. Shake the filter basket slightly to even out the bed of coffee, then close the brew basket.

# OPERATING THE COFFEE MAKER

## COFFEE DOSAGE GUIDE



For best results, use a kitchen scale and the chart below when filling the filter basket with coffee grounds. As a baseline, use medium ground coffee (see picture to the left). Alter grind and/or dosage to taste.

CUPS*	WATER GRAMS	COFFEE GRAMS
2	306	10
3	459	14
4	612	19
5	764	24
6	917	29
7	1070	33
8	1223	38
9	1376	43
10	1529	48
11	1682	52
12	1835	57

\*Use the measurements on the side of your carafe.

# OPERATING THE COFFEE MAKER

## PROGRAMMING THE AUTO FEATURE

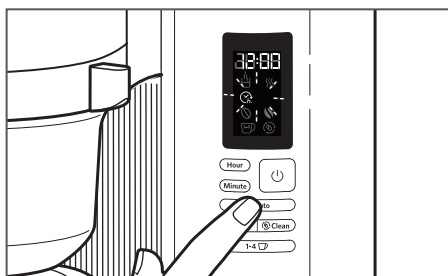

- 1** To program the Coffee Maker to brew coffee at a preset time: Press the AUTO button (☕ Auto) one time. The Auto indicator light will flash and the time display will change to the currently set Auto time (0:00 is the default time.)

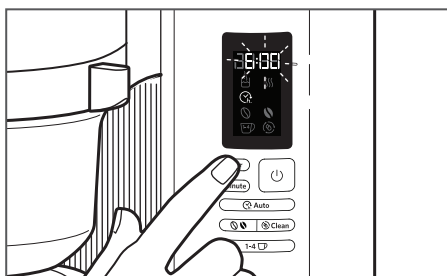

- 2** To set the time the Coffee Maker should begin brewing: Press the HOUR button. The hour digits will change with each press; or press and hold to scroll rapidly. Next, press the MINUTE button. The Hour setting will stay solid, and the Minute setting will begin to blink. The minute digits will change with each press; or press and hold to scroll rapidly.

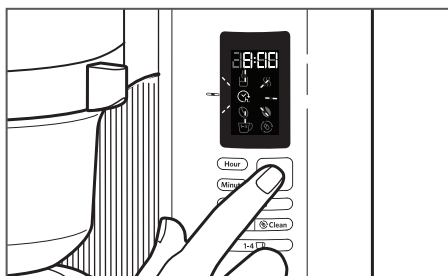

- 3** To save the current displayed time and exit Auto: Wait for 10 seconds, or press any button (☕ Auto, ☕, ☕ Clean, 1-4 ☕, ⏻). The Auto indicator will remain lit and the time display will go back to the current time.

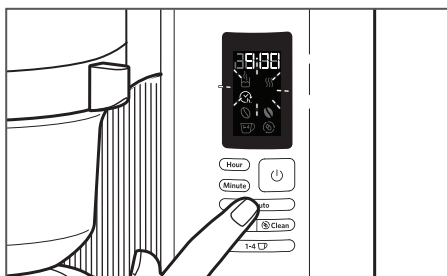

- 4** To cancel the Auto time after programming is complete: Press the AUTO button (☕ Auto) again; or press ⏻.

# OPERATING THE COFFEE MAKER

## USING THE PREVIOUSLY PROGRAMMED AUTO TIME

These steps can be followed to save the Auto time after following the steps in the "Programming the Auto feature" section.

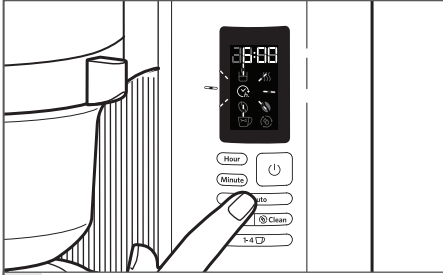

- 1** Press the AUTO button (☺ Auto). The Auto indicator will flash and the time display will show the previously set Auto time.

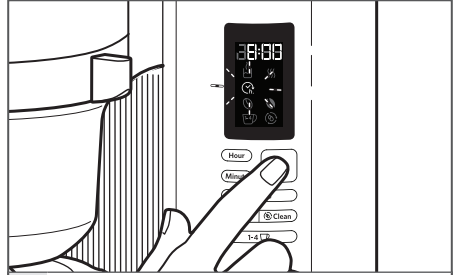

- 2** To save the current displayed time and exit Auto: Wait for 10 seconds, or press any button (☺ Auto, ☹, ☺ Clean, 1-4 ☐, ⏻). The Auto indicator will remain lit and the time display will go back to the current time.



# OPERATING THE COFFEE MAKER

## BREWING COFFEE

**TIP:** Brew two pots of fresh, cool water and discard before brewing the first pot of coffee.

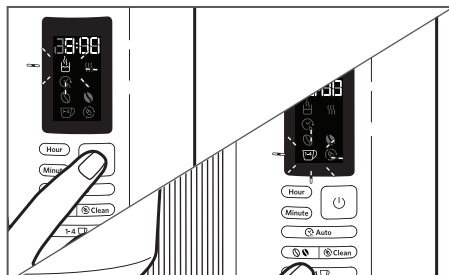

**1** Press the Brew button (⏻) to begin brewing coffee. The Coffee Maker will beep 1 time, and the Brew icon will light up when the Brew cycle is started.

To brew 1-4 cups of coffee instead of an entire pot, press the Small Batch button (1-4 ☒) before pressing the Brew button (⏻). The Small Batch indicator will light up.

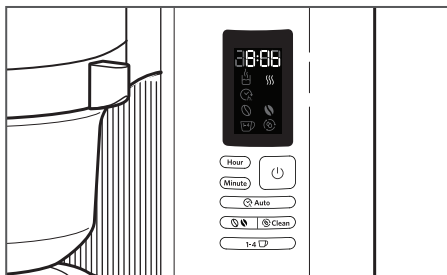

**2** The Coffee Maker will beep three times when the Brew cycle is complete, then will automatically initiate the 30-minute warm mode. The Brewing icon will turn off and the Warming icon will light up. After the warm mode completes, one long beep will sound.

**NOTE:** Opening the brew basket while coffee is brewing will interrupt the brew process and impair flavour.

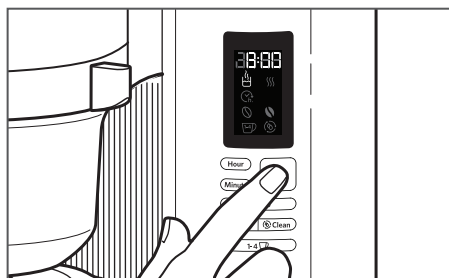

**3** To cancel the Brew cycle or warm mode: Press the Brew button (⏻) once. The Brew cycle or warm mode will be cancelled.

**NOTE:** Repeat steps 1 and 2 to brew additional carafes of coffee. Allow the Coffee Maker to cool for 5 minutes before starting the next brew cycle.

**IMPORTANT:** The outside of the carafe may be warm to the touch after brewing. Use discretion when placing the carafe on uncovered surfaces immediately after brewing.

# CARE AND CLEANING

## CLEANING THE COFFEE MAKER

Calcium deposits (scale) from water will build up in the Coffee Maker over time and impair brewing efficiency and coffee quality. If you notice that it takes longer than usual to brew or that the Coffee Maker is making unusual noises, then it is time to descale. The Clean indicator will flash when the Coffee Maker has completed 100 brew cycles. Descaling should be done as soon as possible to preserve the performance and life of your Coffee Maker.

**NOTE:** The Coffee Maker can be descaled using a vinegar and water solution or by using a packaged descaling agent. Always mix the descaling solution using cool water.

When using vinegar, fill the carafe with a solution consisting of 1/2 vinegar and 1/2 water.

When using a descaling agent, follow the directions on the package for the recommended ratios of descaling agent and water to use.

The Coffee Maker should be run through a complete Clean cycle using a full tank of the descaling solution.

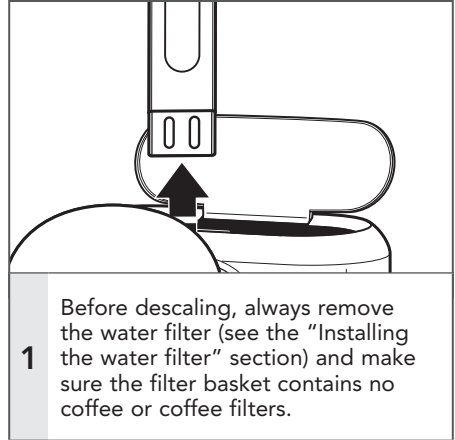

# CARE AND CLEANING

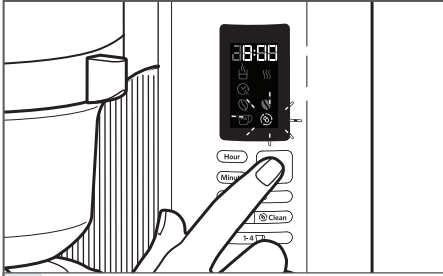

- 2** When the Clean indicator begins to flash on the display, run a clean cycle: Press the Clean button (☼Clean). The Clean indicator will stop flashing. Then press the Brew button to begin the Clean cycle.

When the Clean cycle is complete (approximately 15 minutes), 3 beeps will sound, and the Clean indicator will turn off.

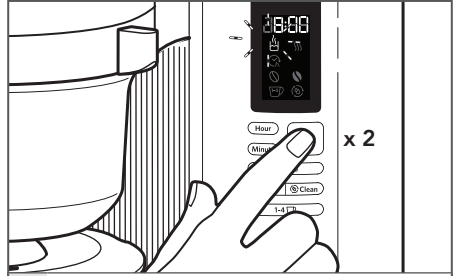

- 3** Run at least two water-only cycles after the Clean cycle is complete.

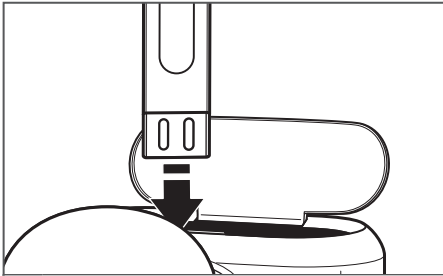

- 4** Reinstall or replace the water filter. Replace the filter every 3 months under normal use. Replace it more often under heavy use.

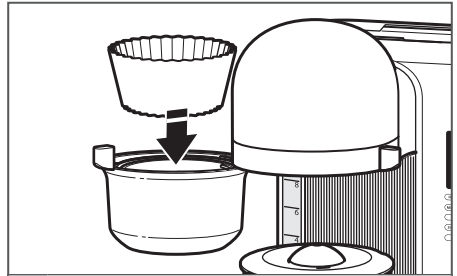

- 5** Reinstall the coffee filter.

**IMPORTANT:** The Clean cycle can be completed at regular intervals, if desired, without the Clean indicator needing to light up. Follow these directions to clean the Coffee Maker whenever desired.

## ⚠️ WARNING



### Electrical Shock Hazard

**Plug into an earthed outlet.**

**Do not remove earth prong.**

**Do not use an adapter.**

**Do not use an extension cord.**

**Failure to follow these instructions can result in death, fire, or electrical shock.**

**If your Coffee Maker should fail to operate as expected, please check the following:**

1. If the display is not illuminated:
  - Check to see whether the Coffee Maker is plugged into a grounded outlet. If it is, check the fuse or circuit breaker on the electrical circuit the Coffee Maker is connected to and make sure the circuit is closed.
2. If only a portion of the water added to the Coffee Maker actually brews:
  - The Coffee Maker requires immediate descaling. Please refer to the "Care and cleaning" section.

3. If you hear three rapid tones:
  - There is no water in the water tank. The Coffee Maker will not brew. Fill the water tank with fresh, cool water and continue with the brewing cycle as described in the "Brewing coffee" section.
4. If "Er1" flashes on the display and you hear one tone:
  - A button may be jammed. Unplug the Coffee Maker and press each button several times. Plug the Coffee Maker into a grounded outlet. If "Er1" appears again on the display, repeat this procedure.
5. If coffee overflows the filter basket:
  - The brew basket is not completely closed. Close the brew basket and ensure it clicks firmly into place.
  - Too much coffee was placed into the filter basket.
6. If water exits from the back of the Coffee Maker:
  - Too much water was poured in to the water tank.

If the problem is not due to one of the above items, see the "Warranty and service" section.

Do not return the Coffee Maker to the retailer as they do not provide service.

# WARRANTY AND SERVICE

## KITCHENAID COFFEE MAKER WARRANTY

Length of Warranty:	KitchenAid Will Pay For:	KitchenAid Will Not Pay For:
Europe, Middle East and Africa: 5KCM1204 Two years full warranty from date of purchase.	The replacement parts and repair labour costs to correct defects in materials or workmanship. Service must be provided by an Authorised KitchenAid Service Centre.	A. Repairs when Coffee Maker is used for operations other than normal household beverage preparation. B. Damage resulting from accident, alterations, misuse, abuse, or installation/operation not in accordance with local electrical codes.

**KITCHENAID DOES NOT ASSUME ANY RESPONSIBILITY FOR INDIRECT DAMAGES.**

## CUSTOMER SERVICE

### In U.K. and Ireland:

For any questions, or to find the nearest Authorised KitchenAid Service Centre, please find our contact details below.

**NOTE:** All service should be handled locally by an Authorised KitchenAid Service Centre.

Contact number for U.K. and Northern Ireland:

Tollfree number 0800 988 1266 (calls from mobile phones are charged standard network rate) or call 0194 260 5504

Contact number for Ireland:

Tollfree number +44 (0) 20 8616 5148

E-mail contact for U.K. and Ireland:

Go to [www.kitchenaid.co.uk](http://www.kitchenaid.co.uk), and click on the link "Contact Us" at the bottom of the page.

Address for U.K. and Ireland:

KitchenAid Europa, Inc.  
PO BOX 19  
B-2018 ANTWERP 11  
BELGIUM

General hotline number:  00800 3810 4026

### In other countries:

For all product related questions and after sales matters, please contact your dealer to obtain the name of the nearest Authorised KitchenAid Service/Customer Centre.

**For more information, visit our website at:**

**[www.KitchenAid.co.uk](http://www.KitchenAid.co.uk)**  
**[www.KitchenAid.eu](http://www.KitchenAid.eu)**

©2017 All rights reserved.

Specifications subject to change without notice.

**KitchenAid**

©2017 All rights reserved.  
Specifications subject to change without notice.